

CURRENT SENSOR BOX OPERATION

(NOT AVAILABLE FOR SWIVEL MODELS)

PART #: S4P-CS

AUTON's current sensor box plugs into your TV lift and will trigger the lift as soon as current is being drawn from the duplex outlet on the platform. You will need an infrared repeater system to trigger the TV when the TV is enclosed in the furniture. (Tv's IR sensor not exposed)
Infrared repeater system can be order separately.

This system is equipped with AUTON's unique "override" switch and can be operated directly from the control box.. Just switch the box to the "off" position and operate with the adjacent toggle switch. Switch back to the "on" position to once again operate the unit with your TV remote.

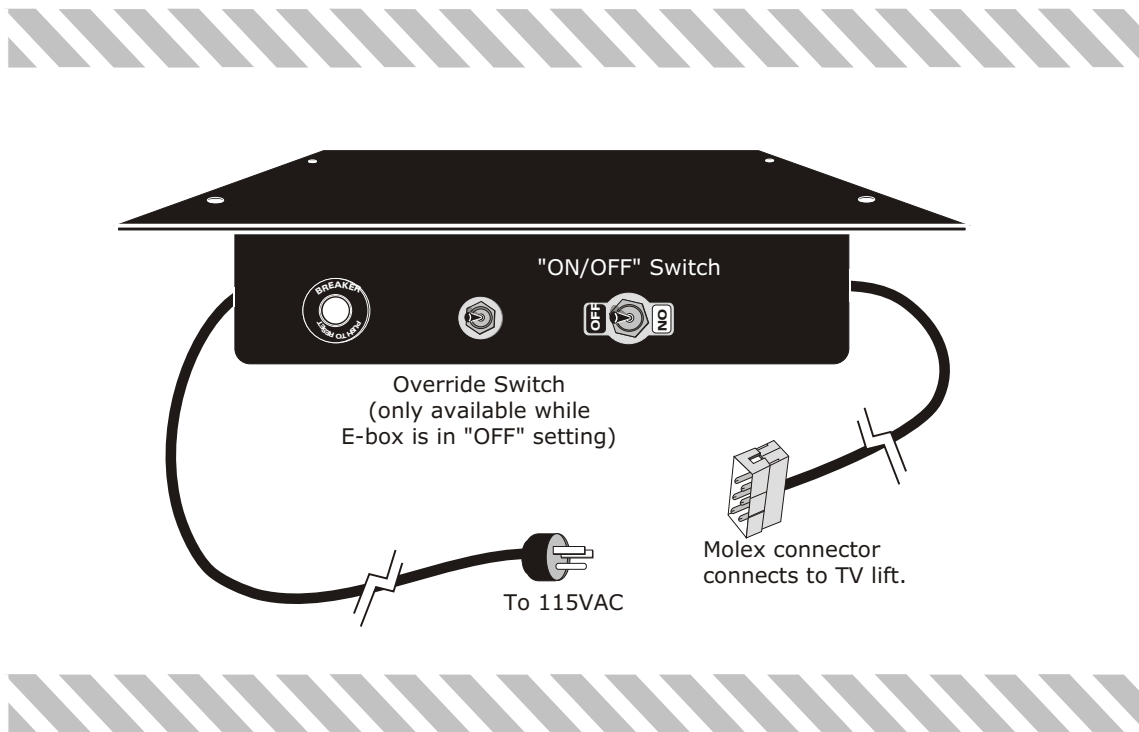

OPTIONAL IR REPEATER SYSTEM

NOTE: IR receiver eye must be mounted into the cabinet in a position where the remote can be aimed directly. Unlike Radio Frequency, The infra-red remote operates on a "line of sight" transmit & receive system.

